



## 657.9

Specially designed to perform difficult trimming operations, these bits are both indispensable and economical. Flush trim bits with two replaceable knives fixed by special TORX® screws. The 2-sided blades can create extra new edges. Guided flush trim bits type **657.1** are equipped with ball bearing guides.



### SAFETY TIPS



The **TW-006** Torque Screwdriver is recommended for the proper fastening of screws (see page 413).

### CORRECT KNIFE POSITIONING

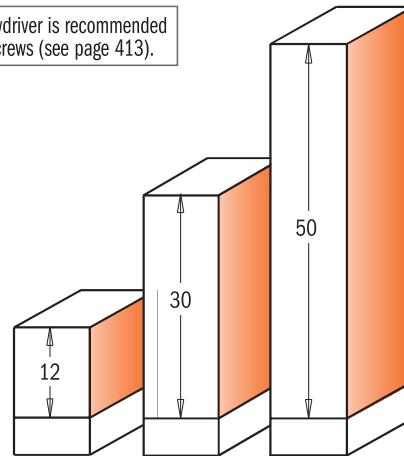
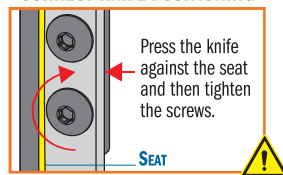

Drawing is 1:1 scale

## 657.1



I mm	D mm	L mm		ORDER NO. S=Ø6mm	ORDER NO. S=Ø6,35mm	ORDER NO. S=Ø8mm	ORDER NO. S=Ø12mm	ORDER NO. S=Ø12,7mm
12	19	57	10	657.194.11	657.192.11	657.190.11		
30	16	75	10			657.161.11		
30	19	76	10	657.195.11				
30	19	77	10			657.191.11		
30	19	87	10					657.692.11
50	19	112	10				657.991.11	657.992.11

### Spare parts

790.120.00	990.075.00	991.061.00	791.007.00
790.295.09	990.115.00	991.061.00	791.006.00
790.300.00	990.075.00	991.061.00	791.007.00
790.300.00	990.075.00	991.061.00	791.007.00
790.300.00	990.075.00	991.061.00	791.007.00
790.500.00	990.075.00	991.061.00	791.007.00

Spare parts: **990.400.00** Ø3.2/Ø7mm shield for M3 screw  
**990.410.00** Ø4.2/Ø9mm shield for M4 screws  
**990.051.00** M3x6mm TCEI screws

**990.052.00** M4x6mm TCEI screws  
**991.067.00** 3mm hex key  
**541.514.00** Ø6,4mm shield

## FILE-FREE Flush Trim Bits for Laminate

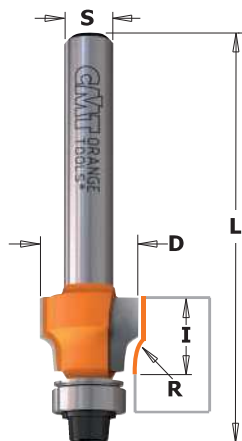

## 8/907

This bit is perfect for ensuring smooth flawless results on your laminate surfaces after flush trimming. Sharp edges are easily trimmed away, leaving your surfaces nice and smooth to the touch. No further filing is needed!

**SHOP TIPS:** after resharpening, replace bearing 791.002.00 (Ø9,5mm) with undersized bearing **791.062.00** (Ø9,3mm)

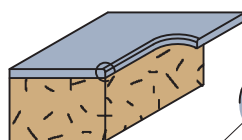

Drawing is 1:1 scale

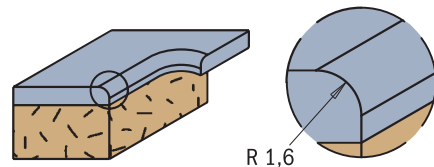

D mm	I mm	R mm	L mm		ORDER NO. S=Ø6,35mm	ORDER NO. S=Ø8mm
12,7	9,5	0,4	52	10	807.004.11	907.004.11
12,7	9,5	1,6	52	10	807.015.11	907.015.11

### Spare parts

990.422.00	791.002.00	990.058.00	991.057.00
990.422.00	791.002.00	990.058.00	991.057.00